

AUX. 7

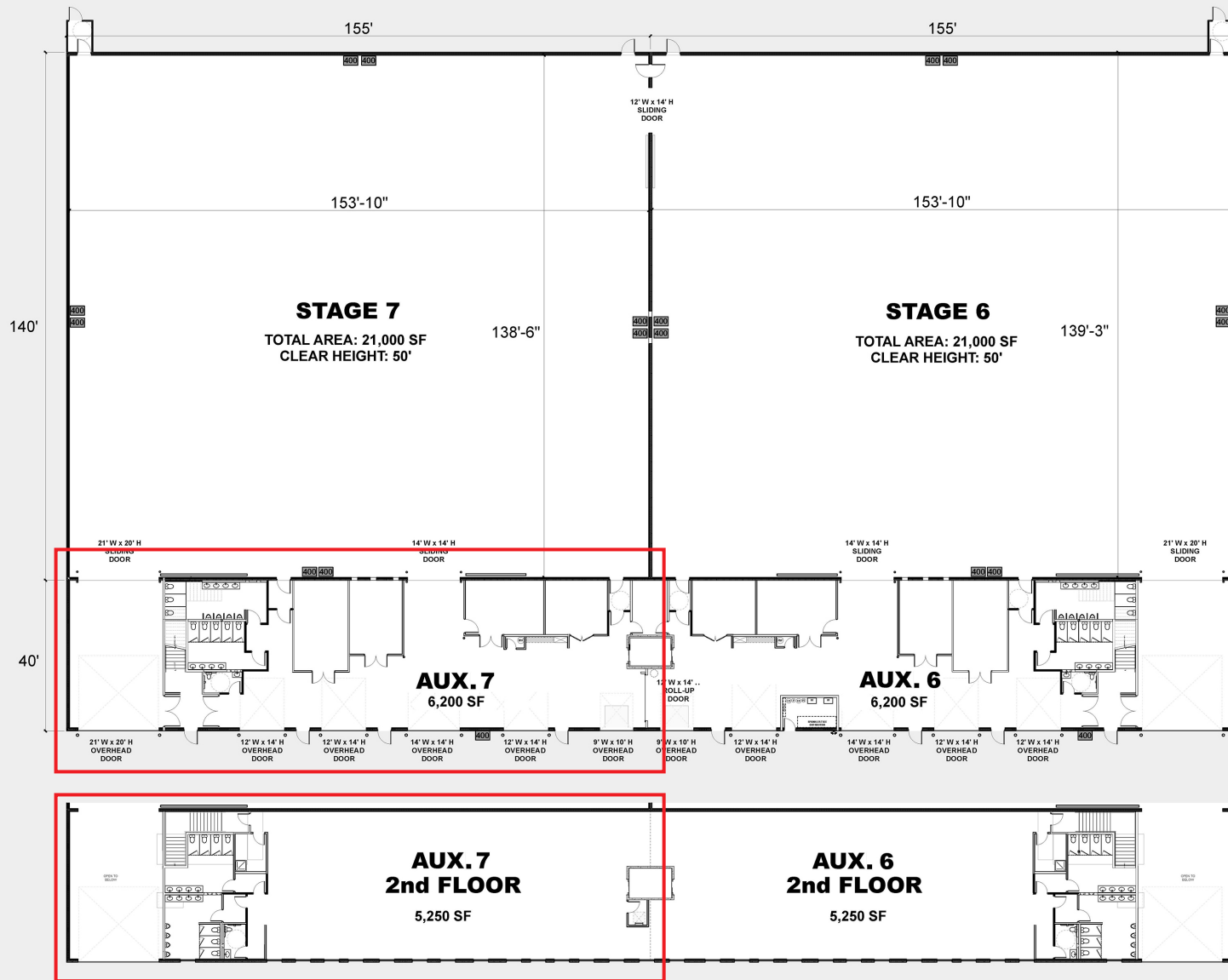

- 11,450 Sq. Ft.
- AC/In-floor Heating
- Shared Freight Elevator
- 3 Ground-level Loading Doors
- 2 Ground-level Stage Entrance Doors
- 1 Dock-level Loading Door
- 3 Department Lock-ups
- Paint Sinks
- High-Speed WiFi
- Keycard/Keypad Access System

- Located within Calgary City Limits
- 20 minutes to Downtown & International Airport
- Ample room for Crew/Circus/ Basecamp Parking
- 14 Acres Backlot for Exterior Builds
- Purpose-built support buildings adjacent to Stage: Wardrobe, Mill, Set Dec. & Furnished Production Offices



ROCKY MOUNTAIN FILM STUDIO

NORTH CAMPUS

6999 84 Street SE, Calgary, Alberta, Canada T2C 4T6

For more information contact:
Scott Evans, Executive Vice President
 604.928.5050
 scott@rockymountainfilmstudio.com
 rockymountainfilmstudio.com